

A2@T Clamp

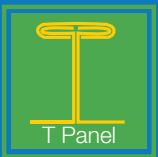

- Modeled after the ML™ and offers side versus top securing, making it **more versatile for solar applications**
- Pre-assembled clamp allows for a quick and easy installation
- Non-penetrating sliding pin design does not damage the panel
- High wind-load resistance
- Available for two or three-hole brackets (2-6 inches in height)
- Engineered for bulb-style and T-panel seams
- Aircraft quality aluminum
- All stainless-steel hardware
- **Installs in half the time of competitive products***



Shown: Part# 5056-T



Specifications

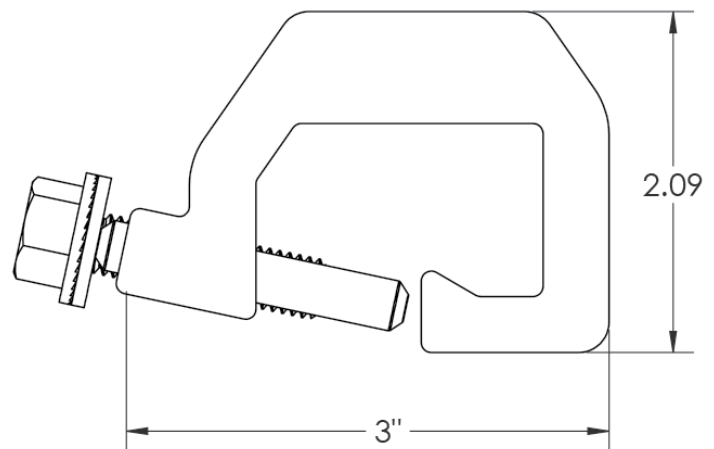
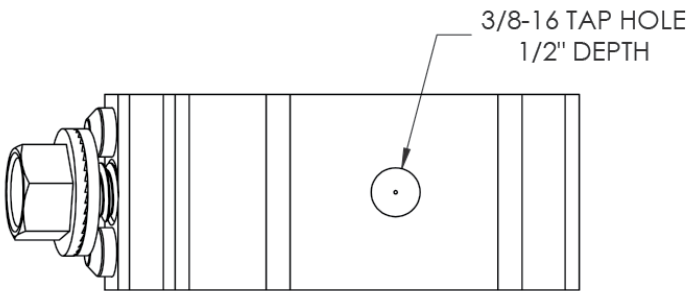

RECOMMENDED TORQUE SPECS

	24ga steel	Aluminum	Copper
A2@T	175	135	n/a

The above is a general recommendation which varies by material type and panel thickness. For additional panel profiles and torque specs visit www.AceClamp.com

